

Selective Photodiode

EPD-470-5/0,5

Spectral range	Type	Technology	Case
Blue-green	Waterclear	GaP	5 mm plastic lens

Description

Narrow response range (470 nm peak),

Applications

Optical communications, safety equipment, automation, analytics

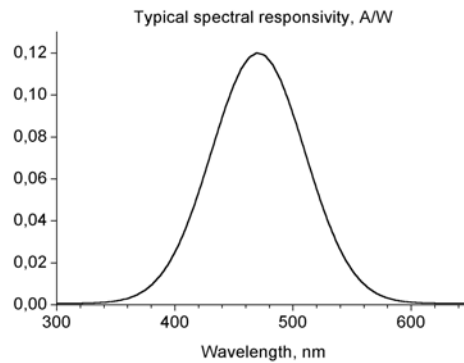
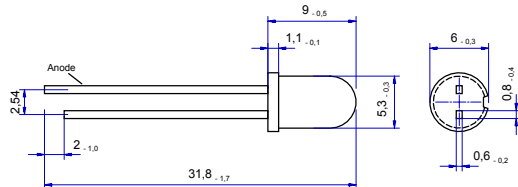

Maximum Ratings

Parameter	Value	Unit
Storage Temperature	- 40...+85	°C
Operating Temperature	- 40...+85	°C
Soldering Temperature	260	°C

Optical and Electrical Characteristics

$T_{amb} = 25^{\circ}\text{C}$, unless otherwise specified

Parameter	Test conditions	Symbol	Min	Typ	Max	Unit
Active area		A		0.13		mm ²
Peak sensitivity, typ.		λ_{Smax}		470		nm
Spectral bandwidth at 50%		$\Delta\lambda_{0,5}$		80		nm
Acceptance angle at 50% S_{λ}				20		deg.
Responsivity at 660 nm	$V_R = 0\text{ V}$	S_{λ}		0.12		A/W
Dark current	$V_R = 5\text{ V}, E_e=0$	I_D		20	50	pA
Reverse voltage	$I_R = 10\text{ }\mu\text{A}$	V_R		10		V

*Light source is an AlGaAs LED with a peak emission wavelength of 470 nm